

TO BE ASSEMBLED BY AN ADULT

# Wheelbarrow

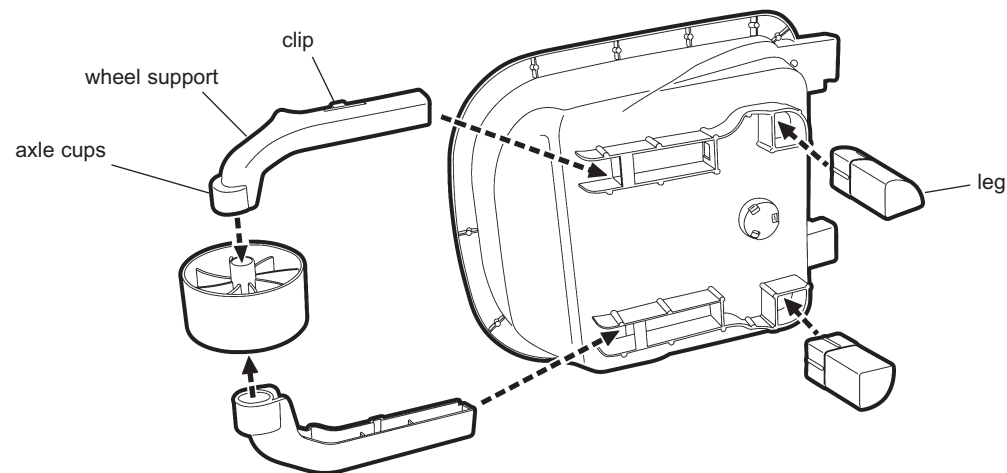

- 1 Place the axle cups at the ends of the 2 wheel supports over the wheel axle ends as illustrated to form the wheel assembly.
- 2 Locate the ends of the wheel assembly into the brackets on the base of the wheelbarrow, ensuring the clips face upwards. Push firmly until the clips locate into the holes in the base of the wheelbarrow.
- 3 Push the 2 legs into the brackets on the base wheelbarrow as illustrated.
- 4 Push the handle ends into the bracket on the wheelbarrow firmly until the clips locate into the bottom of the bracket.

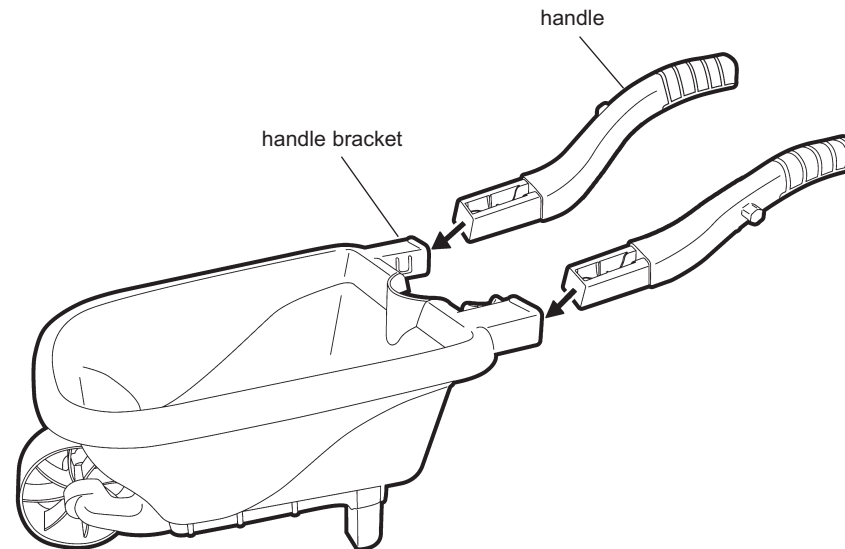

For added fun you can decorate your wheelbarrow and watering can with the sheet of stickers supplied.

### SAFETY FIRST

Please check all fixings are secure before handing to a child.  
Ensure an adult regularly checks all fixings.

### WARNINGS

Do not allow children to sit or ride in this toy.  
Check regularly for wear and tear.  
Discontinue use if breakage is found. Failure to do this may result in injury.

*Please retain this leaflet for reference to the manufacturer.*

**Product No. M08215**

Made in China to European Safety Standards

DISTRIBUTED BY



**MV SPORTS & LEISURE LTD**  
35 Tameside Drive • Castle Bromwich  
Birmingham • B35 7AG • UK  
Email: info@mvsports.com  
www.mvsports.com



### CUSTOMER HELPLINE

We make every effort to ensure that this product reaches you in satisfactory condition.

However if you have any queries, need assistance, or find this product defective, please call our Customer Helpline:

**0870 8404255** (UK ONLY)